

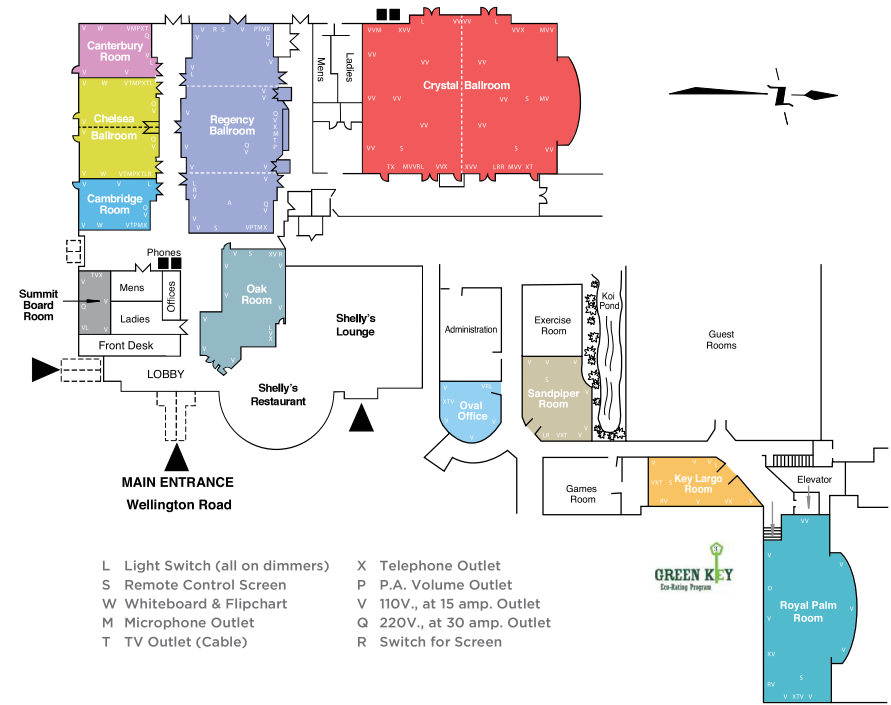

# Corporate Functions

Whether you're planning an **executive retreat** or a company-wide **business conference**, the Lamplighter Inn & Conference Centre has the right meeting rooms and spaces to accommodate you.

For large meetings, the hotel has **3 beautiful ballrooms** that can accommodate **up to 800 guests**. For smaller groups there are 12 additional meeting rooms. Each room contains all the **AV equipment** necessary to host any event.



- L Light Switch (all on dimmers)
- S Remote Control Screen
- W Whiteboard & Flipchart
- M Microphone Outlet
- T TV Outlet (Cable)
- X Telephone Outlet
- P P.A. Volume Outlet
- V 110V., at 15 amp. Outlet
- Q 220V., at 30 amp. Outlet
- R Switch for Screen

# Special Occasions

The Lamplighter Inn & Conference Centre is the perfect spot to host your **special event**, whether it's a birthday party in our **Atrium Oasis**, a cocktail party in one of our **beautiful ballrooms** or a family reunion.

Our **delicious menu** options and dedicated **catering staff** will ensure your event is a success that guests will be talking about for years to come.



# A Beautiful Beginning

Before you spend the rest of your lives together, show the world how much you love each other in your own special way. Lamplighter Inn & Conference Centre has been that special place to celebrate love, hosting **memorable weddings** for generations.

We've been **cozy and intimate**, or **large and extravagant**. Whatever your style is, we understand that every couple is unique and we're here to help you paint the perfect picture of your special love.

Contact us to receive our personal wedding planner with all the information you need to make your dream wedding a reality.

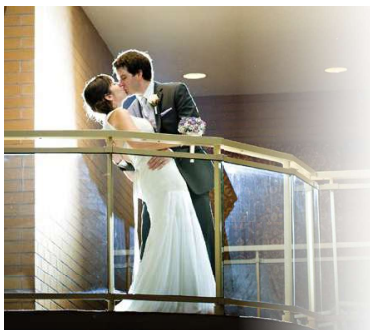

	SIZE (FT)	SQUARE FEET	CEILING HEIGHT	U-SHAPE STYLE	THEATRE STYLE	CONFERENCE STYLE	CLASSROOM STYLE	BANQUET STYLE
<b>MAIN FLOOR</b>								
Crystal Room	105' x 66'	7000	21'	-	800	-	350	540
Crystal North	55' x 66'	3550	21'	-	425	-	170	240
Crystal South	50' x 66'	3450	21'	-	350	-	150	220
Regency Room	101' x 42'	4320	12'	-	500	-	250	380
Regency A/C	33' x 40'	1320	12'	36	120	48	65	100
Regency A+B/B+C	68' x 42'	3000	12'	-	375	-	150	250
Regency B	35' x 48'	1680	12'	50	150	60	65	100
Centerbury Room	25' x 31'	775	12'	25	75	30	32	50
Chelsea Room	50' x 36'	1900	12'	60	180	72	80	140
Chelsea 1	25' x 36'	950	12'	28	85	40	40	60
Chelsea 2	25' x 36'	950	12'	28	85	40	40	60
Cambridge Room	25' x 28'	705	12'	20	70	25	28	40
Summit Board Room	12' x 24'	288	12'	-	25	12	-	12
<b>DECK LEVEL</b>								
Royal Palm Room	-	1865	-	60	160	72	72	100
Key Largo Room	-	450	-	20	40	24	-	24
Sandpiper Room	-	400	-	20	35	24	-	24
Oval Office	-	260	-	10	25	12	-	12
Oak Room	32' x 38'	1056	9'	36	85	24	40	70